

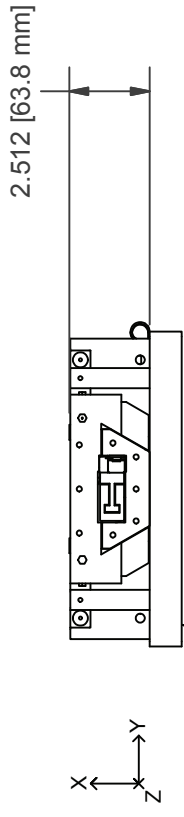

CABLE EXIT

AIR SUPPLY - (SEE SPECIFICATIONS)
1/4 INCH QUICK DISCONNECT AIR FITTING
(OPTIONAL 5/32 INCH OR 4MM FITTING)

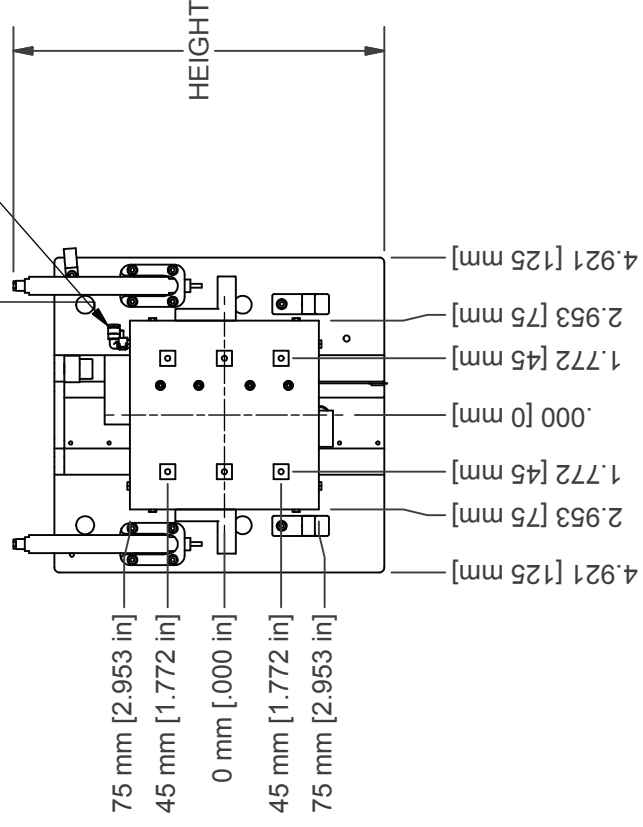

ALIO PROVIDES ALUMINUM, STEEL,
OR GRANITE BASE PLATE PER
SPECIFICATIONS AND TRAVEL.

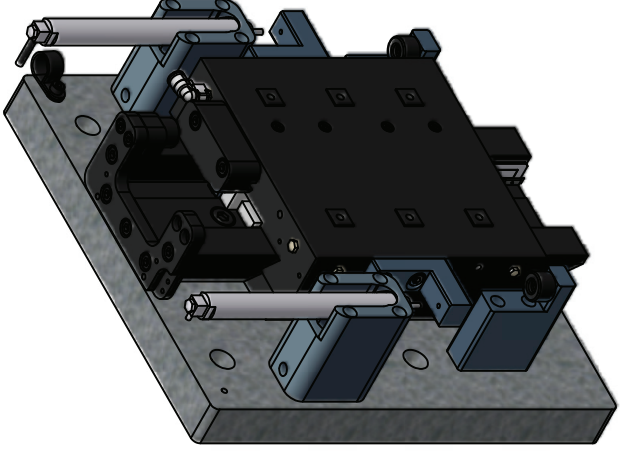
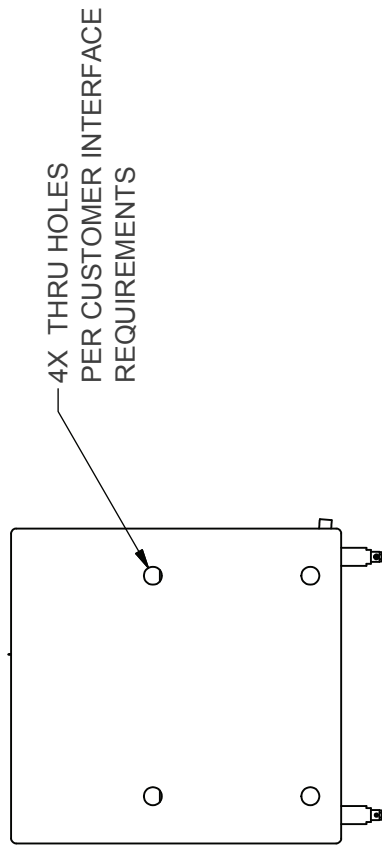

STANDARD FEATURES

Stage	Dovetail Air Bearing Z Stage
Travel	50mm to >150mm
Motor	Ironless Core Linear Motor
Feedback	Non-Contact Optical Encoder
Scale	Gold Tape Scale Optional: Near Zero CTE ZeroMet
Resolution	1Vp-p Analog Output (5nm with 4096 Interpolation) Digital Output Options: 5um, 1um, 0.5um, 0.2um, 100nm, 50nm, 20nm**, 10nm**, and 5nm** (* ** Reduced Speeds Apply)
Sensors	Integrated Home and End of Travel Limits
Bearings	Porous Media Air Bearings
Counterbalance	Frictionless Pneumatic Cylinder
Cables	High Flex, 10M Cycle, 3m Length Optional: Trackless Cable Management System
Structure	Anodized Aluminum 6061-T6
Base Structure	Granite, Aluminum, or Steel Designed per System Requirements
Environment	Standard
Temperature	0°C to 50°C
Humidity	10% to 80% Non-Condensing
Precision	6-D Nano Precision™ Test Methods

TRAVEL	HEIGHT
50	303
100	379
150 +	VARIOUS

* All units millimeters unless otherwise noted.
* All hole patterns centered on stage carriage.
* Custom and intermediate sizes available.

A

DRAWN NBROWN 5/12/2012



TITLE

AI-LM-(TRAVEL)00-AB-Z-CB

SIZE

B

DWG NO

0010-08019

REV

001

SCALE

FINISH SEE NOTES

ALIO STD TEMPLATE - REV 006

SHEET 1 OF 1

NOTE: MODEL AI-LM-50000-AB-Z-CB SHOWN.

1

2

3

4

B

B

A

A

4

3

2

1