

4

3

2

1

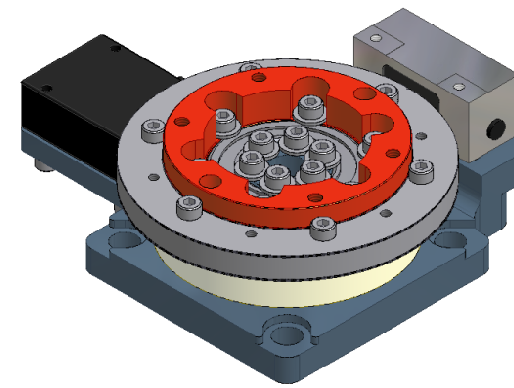
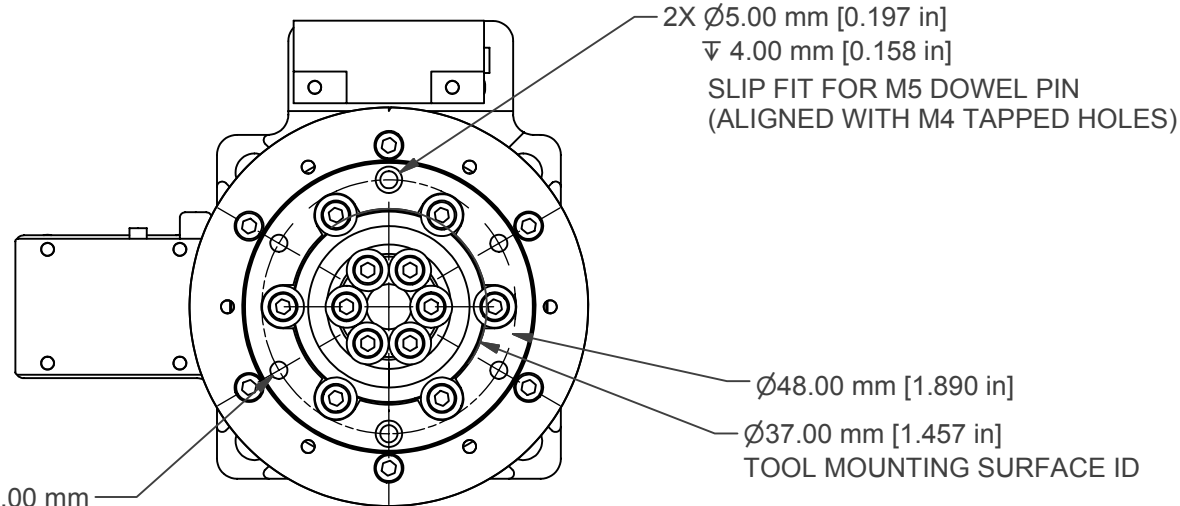

STANDARD FEATURES

- MOTOR: HR-2
- STD TORQUE 0.12 N-m
(CONSULT FACTORY FOR HIGHER FORCE)
- ROTATION: 360 DEGREES CONTINUOUS
- SPEED: >360 DEG/SEC
- ENCODER RESOLUTION: 0.03 ARC-SEC TO 27 ARC-SEC
0.03 ARC-SEC USING 4096 INTERPOLATION
(CONTROLLER DEPENDENT)
- SYSTEM REPEATABILITY: +/- 1 ENCODER COUNT
(CONTROLLER DEPENDENT)
- HOME SENSOR: STANDARD
- BEARINGS: PRECISION CROSSED ROLLER
- BEARING DYNAMIC LOAD RATING: 3 kN
- SYSTEM LOAD CAPACITY: APPLICATION DEPENDENT
PLEASE CONSULT THE FACTORY
- ENCLOSURES: ALUMINUM 6061-T6
STAINLESS STEEL OPTIONAL
- ENVIRONMENT: STANDARD, CLEANROOM, VACUUM
10e-7 TORR, AND VACUUM 10e-10 TORR
(CONSULT FACTORY)
- TEMPERATURE: 0 to 85 DEG C
- HUMIDITY: 10% to 80% NON-CONDENSING
- ASSEMBLY MASS: 0.48 kg

ACCESSORIES

- MOTOR AMPLIFIER
- ROTATION LIMIT MARKERS
- OPTIONAL HARDSTOPS

OPTIONAL EQUIPMENT
MOTION CONTROLLERS

CUSTOM DESIGNS FOR OEM INTEGRATION

ALIO INDUSTRIES PROPRIETARY INFORMATION

11919 W I-70 FRONTAGE ROAD NORTH, UNIT 119, WHEAT RIDGE, CO 80033 USA
(Tel) 303.339.7500 - SALES@ALIOINDUSTRIES.COM - WWW.ALIOINDUSTRIES.COM



AI-40R

DRAWN	NBROWN	3/3/2005	TITLE		
CHECKED					
Tolerances: x.x ± .04 in x.xx ± .02 in x.xxx ± .005 in			REV		
MATERIAL					
SIZE	B	DWG NO	00478	REV	002
SCALE		SHEET	1	OF	2

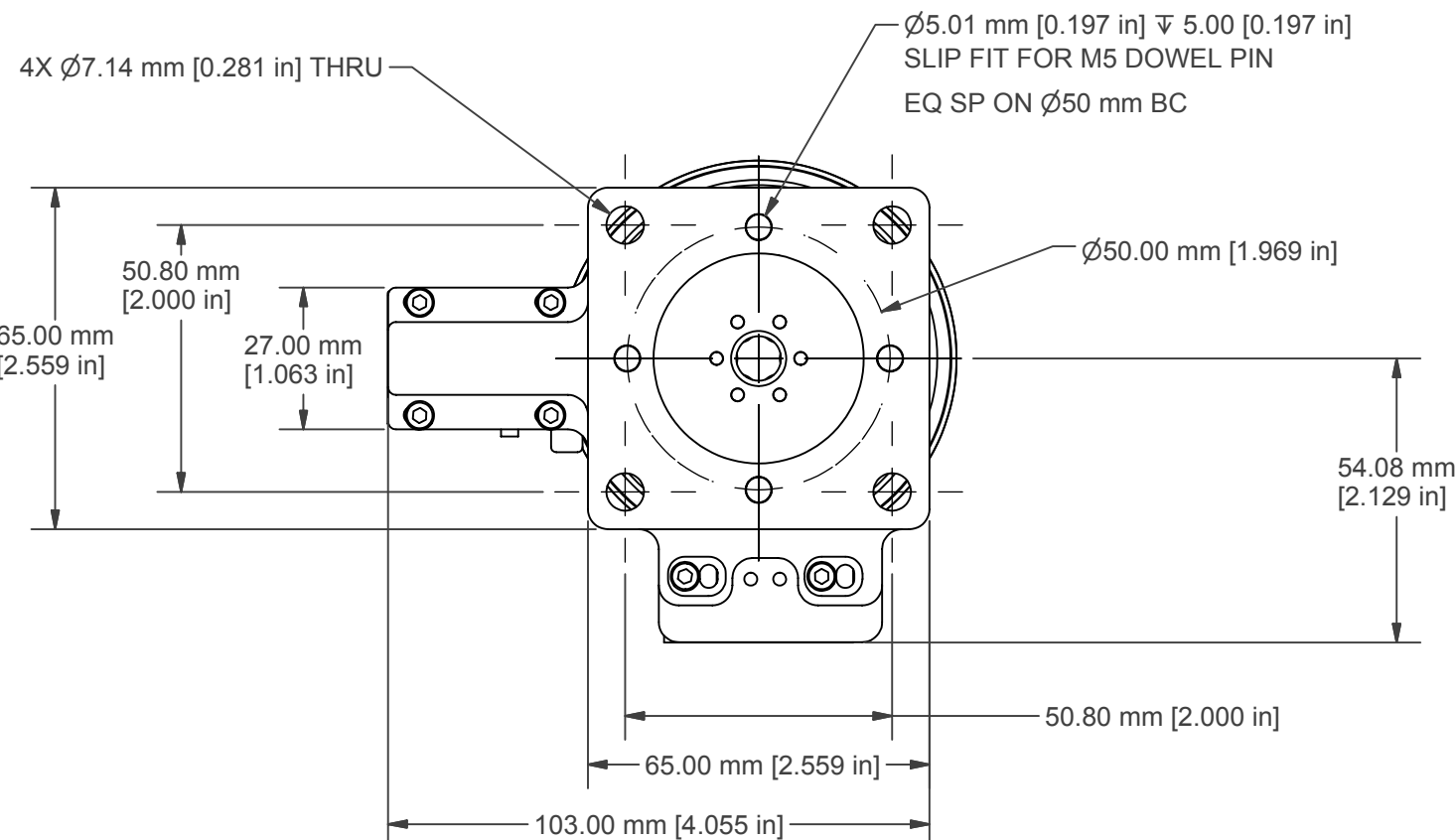
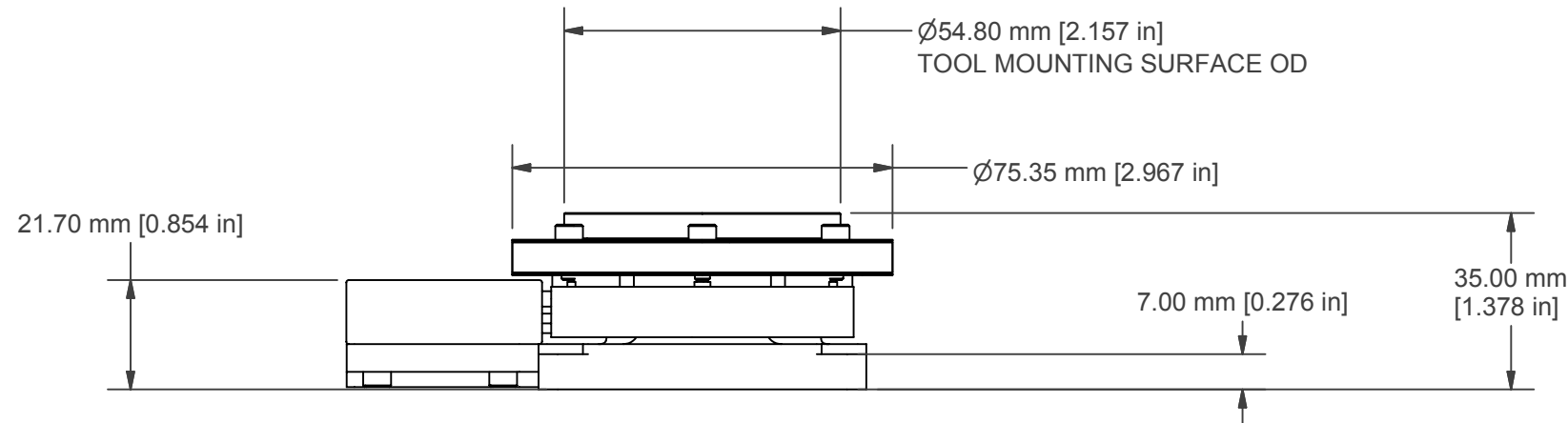

4

3

2

1

B

B

A

A